

Assessment Test for Singapore Primary Mathematics 3B Standards Edition

This test covers material taught in Primary Mathematics 3B Standards Edition
(<http://www.singaporemath.com/>)

1. What measuring unit would you use to measure the following? Fill in the blanks with centimeter, meter, kilometer, gram, kilogram, milliliter, or liter.
- (a) The weight of a marble. _____ [1]
- (b) The width of a piece of paper. _____ [1]
- (c) The capacity of a cup. _____ [1]
- (d) The capacity of a fish tank. _____ [1]
- (e) The length of a swimming pool. _____ [1]

2. What measuring unit would you use to measure the following? Fill in the blanks with inch, foot, yard, mile, ounce, pound, pint, quart, or gallon.
- (a) The capacity of a swimming pool. _____ [1]
- (b) The distance from Texas to Phoenix. _____ [1]
- (c) The weight of a person. _____ [1]
- (d) The length of your foot. _____ [1]
- (e) The weight of an apple. _____ [1]

3. Write $>$, $<$, or $=$ in each \bigcirc
- (a) 3 qt 3 pt \bigcirc 1 gal (b) 3 km 6 m \bigcirc 3600 m [2]
- (c) 1 mile \bigcirc 1 km (d) 2 months \bigcirc 50 days [2]
- (e) 2 h \bigcirc 210 min (f) 3 weeks 5 days \bigcirc 26 days [2]

Copyright © 2008 [SingaporeMath.com Inc.]. All rights reserved.

This assessment test and answer key may be printed out and used by individuals at no cost. They may not be copied or incorporated into any other document. Please see legal (<http://www.singaporemath.com/terms.asp>) for more information.

4. Fill in the blanks.

(a) $5 \text{ m} - 3 \text{ m } 45 \text{ cm} = \underline{\hspace{2cm}} \text{ m } \underline{\hspace{2cm}} \text{ cm}$ [1]

(b) $3 \text{ kg } 250 \text{ g} - 1 \text{ kg } 600 \text{ g} = \underline{\hspace{2cm}} \text{ kg } \underline{\hspace{2cm}} \text{ g}$ [1]

(c) $5 \text{ h } 10 \text{ min} - 3 \text{ h } 25 \text{ min} = \underline{\hspace{2cm}} \text{ h } \underline{\hspace{2cm}} \text{ min}$ [1]

(d) $4 \text{ yd } 1 \text{ ft} - 1 \text{ yd } 2 \text{ ft} = \underline{\hspace{2cm}} \text{ yd } \underline{\hspace{2cm}} \text{ ft}$ [1]

(e) $6 \text{ ft } 7 \text{ in.} + 2 \text{ ft } 10 \text{ in.} = \underline{\hspace{2cm}} \text{ ft } \underline{\hspace{2cm}} \text{ in.}$ [1]

(f) $3 \text{ lb} - 2 \text{ lb } 5 \text{ oz} = \underline{\hspace{2cm}} \text{ lb } \underline{\hspace{2cm}} \text{ oz}$ [1]

(g) $13 \text{ gal } 1 \text{ qt} - 2 \text{ gal } 3 \text{ qt} = \underline{\hspace{2cm}} \text{ gal } \underline{\hspace{2cm}} \text{ qt}$ [1]

(h) $3 \text{ h } 20 \text{ min} + 1 \text{ h } 45 \text{ min} = \underline{\hspace{2cm}} \text{ h } \underline{\hspace{2cm}} \text{ min}$ [1]

5. The length of board A is 3 ft 4 inches. The length of board B is 45 inches. Which is longer? How much longer? [3]

6. A melon is 5 times as heavy as an orange. If the orange weighs 450 g, find the difference in weight between the orange and the melon. Give your answer in kilograms and grams. [3]

7. Peter weighs 40 lb 10 oz. Paul weighs 1 lb 12 oz less than Peter. [3]
Mary weighs 2 lb 4 oz more than Paul. What is the total weight of
the three children?

8. String A is 85 cm long. String B is twice as long. String C is 30 cm [4]
shorter than string B. How long is string C? Give your answer in
meters and centimeters.

9. John took 2 h 40 min to paint his room. He finished at 1:30 p.m. [3]
What time did he begin painting his room?

10. Fill in the blanks. [2]
(a) 7 quarters = \$_____ (b) 15 nickels = \$_____

11. The sum of 6 one-dollar bills, 5 quarters, 8 dimes, 5 nickels, and 14 [2]
pennies is \$_____

12. Solve using mental math:

(a) $\$15.60 + 45\text{¢} = \$______$ (b) $\$15.35 + \$35.75 = \$______$ [2]

(c) $\$100 - \$53.80 = \$______$ (d) $\$10.05 - \$5.35 = \$______$ [2]

(e) $400\text{¢} \times 3 = \$______$ (f) $\$3.60 \div 6 = \$______$ [2]

13. Solve:

(a)
$$\begin{array}{r} \$35.92 \\ + \$23.86 \\ \hline \end{array}$$

(b)
$$\begin{array}{r} \$60.05 \\ - \$33.17 \\ \hline \end{array}$$
 [2]

(c)
$$\begin{array}{r} \$13.90 \\ \times 7 \\ \hline \end{array}$$

(d) $5 \overline{) \$41.00}$ [2]

14. Mr. Green bought some vegetables for \$8.50 and fish for \$12.95. He had \$32.30 left. How much money did he have at first? [3]

15. A 10 oz. carton of strawberries at a farmer's market costs \$2. Hallie wants to buy strawberries only if they are less than \$3 a pound. Should she buy the strawberries? Show your work. [3]

16. Find the missing numbers for the top or bottom of the fractions.

(a) $\frac{2}{3} = \frac{\square}{12} = \frac{4}{\square}$

(b) $\frac{6}{18} = \frac{\square}{6} = \frac{1}{\square}$ [2]

17. Circle the larger fraction.

(a) $\frac{4}{5}$ $\frac{4}{9}$

(b) $\frac{2}{3}$ $\frac{5}{6}$ [2]

18. Express each of the following fractions in its simplest form.

(a) $\frac{6}{10}$

(b) $\frac{3}{9}$ [2]

19. Solve.

(a) $\frac{3}{7} + \frac{2}{7} =$

(b) $1 - \frac{3}{10} =$ [2]

(c) $\frac{1}{3}$ of 9 =

(d) $\frac{3}{4}$ of \$1.00 = _____¢ [2]

20. Peter, Sam, and Mary shared a pizza. Peter and Sam each had $\frac{2}{5}$ of the pizza. How much pizza did Mary have? [2]

21. Melissa ate $\frac{2}{6}$ of a pie. Sara ate $\frac{1}{2}$ of the pie.

(a) Who ate a bigger portion of the pie? _____ [1]

(b) How much pie was left over? _____ [1]

22. Alex has 2 quarters, 1 dime, and 2 nickels.
- (a) What fraction of his coins are quarters? _____ [1]
- (b) What fraction of a dollar does he have? _____ [1]

23.

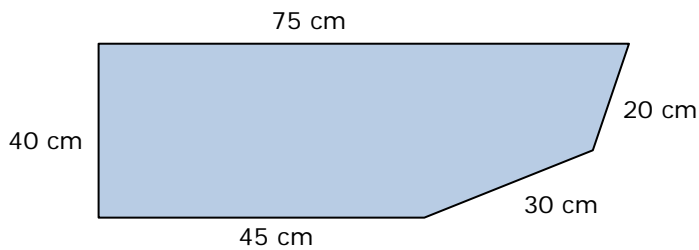

- (a) The perimeter of this figure is _____ m _____ cm [2]
- (b) What type of polygon is this figure? [1]
 quadrilateral pentagon hexagon octagon
- (c) The figure has _____ right angles, _____ angles greater than a right angle, and _____ angles smaller than a right angle. [2]

24. The length of a rectangular field is 60 yd and its width is 25 yd. Sam ran around the field three times. How far did he run? [3]

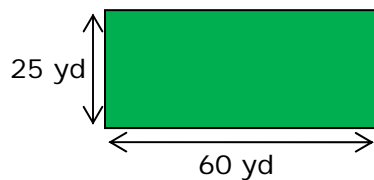

25. Each of these shapes is a quadrilateral.

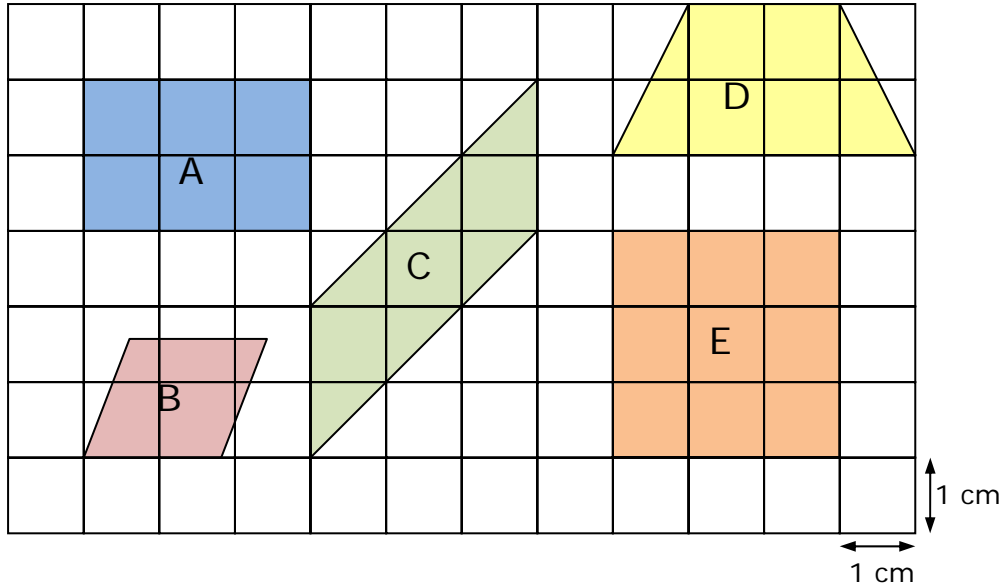

- (a) Which shapes are parallelograms? _____ [1]
- (b) Which shapes have the same area? _____ [1]
 What is that area? _____ cm^2 .
- (c) Which shape is a rhombus? _____ [1]
- (d) Which shape is a trapezoid? _____ [1]
- (e) Write the name of the shape that has four equal angles and four equal sides. _____ [1]

- (f) Draw another shape here with the same area as the rectangle but with a different perimeter.

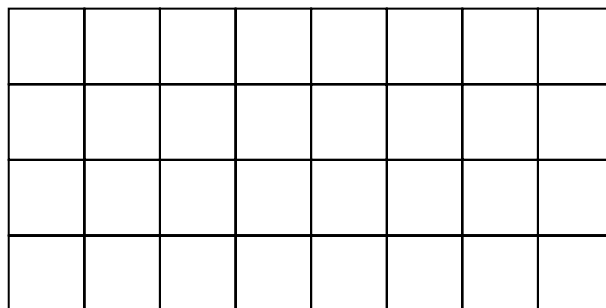

26.

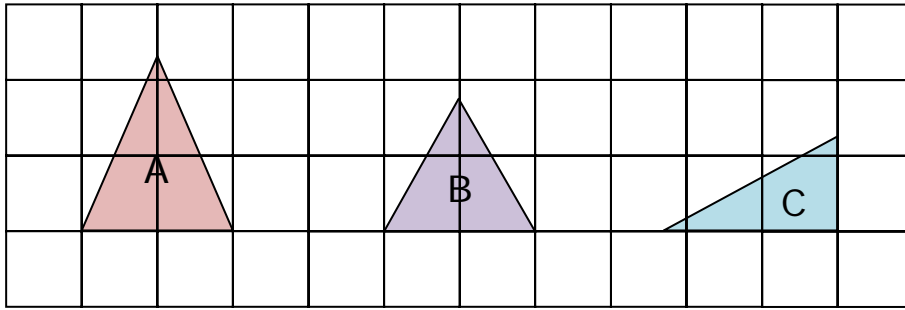

- (a) Are these triangles polygons? _____ [1]
- (b) Which triangle is equilateral? _____ [1]
- (c) Which triangle is isosceles? _____ [1]
- (d) Which triangle is scalene? _____ [1]
- (e) Which triangle is a right triangle? _____ [1]

27. Circle the names of the 2 shapes that make up this solid. [2]

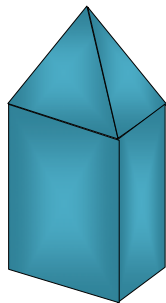

- | | |
|----------|--------|
| Cube | Cone |
| Pyramid | Sphere |
| Cylinder | Prism |

28.

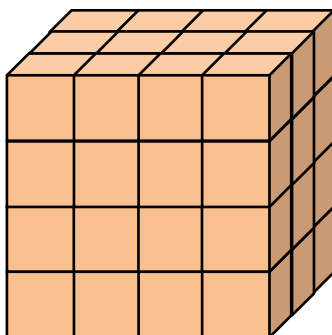

What is the volume of this solid? [2]

_____ cubic units

Answer Key

1. (a) gram (b) centimeter
(c) milliliter (d) liter
(e) meter
2. (a) gallon (b) mile
(c) pound (d) inch
(e) ounce
3. (a) > (b) <
(c) < (d) >
(e) < (f) =
4. (a) 1 m 55 cm (b) 1 kg 650 g
(c) 1 h 45 min (d) 2 yd 2 ft
(e) 9 ft 5 in. (f) 0 lb 11 oz
(g) 10 gal 2 qt (h) 5 h 5 min
5. B; 5 in.
6. 1 kg 800 g
7. 120 lb 10 oz
8. 1 m 40 cm
9. 10:50 a.m.
10. (a) \$1.75 (b) \$0.75
11. \$8.44
12. (a) \$16.05 (b) \$51.10
(c) \$46.20 (d) \$4.70
(e) \$12.00 (f) \$0.60
13. (a) \$59.78 (b) \$26.88
(c) \$97.30 (d) \$8.20
14. \$53.75
15. No
16. (a) 8; 6 (b) 2; 3
17. (a) $\frac{4}{5}$ (b) $\frac{5}{6}$
18. (a) $\frac{3}{5}$ (b) $\frac{1}{3}$
19. (a) $\frac{5}{7}$ (b) $\frac{7}{10}$
(c) 3 (d) 75
20. $\frac{1}{5}$
21. (a) Sara (b) $\frac{1}{6}$
22. (a) $\frac{2}{5}$ (b) $\frac{7}{10}$
23. (a) 2 m 10 cm (b) pentagon
(c) 2; 2; 1
24. 510 yd
25. (a) A, B, C, E (b) A, C, D; 6
(c) B (d) D
(e) square (f) check drawing
26. (a) yes (b) B
(c) A (d) C
(e) C
27. Pyramid, Prism
28. 48